

9/16" BORE BRASS HEAVY DUTY CYLINDER



Consult factory for hydraulic applications

Note: Maximum recommended hydraulic working pressure for heavy duty cylinders is 1000 psig.

H9C-□D

Mount: Clevis **Available Stroke Lengths:** 1", 2", 3", 4", 5", 6"
Type: Double Acting

To order: Indicate stroke in box □

Add **-N** to the end of the part number for a non-threaded rod

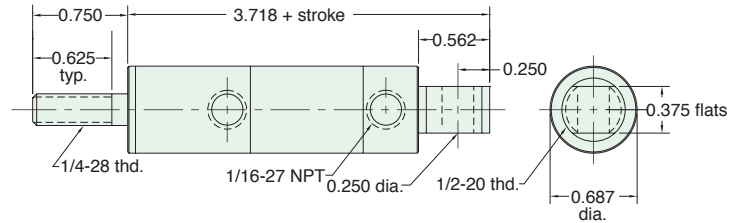

Nuts included, but not shown on drawing

H9U-□S

Mount: Universal
Type: Single Acting Spring Return

Stroke Length "L"	1"	2"	3"
	4.375"	6.031"	7.687"

To order: Indicate stroke in box □

Add **-N** to the end of the part number for a non-threaded rod

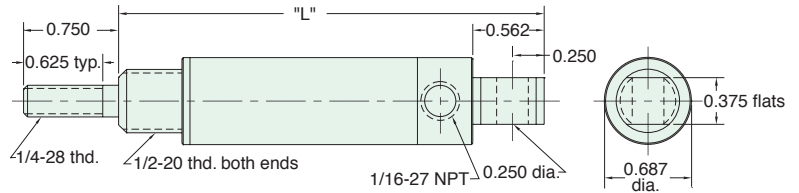

Nuts included, but not shown on drawing

H9U-□D

Mount: Universal **Available Stroke Lengths:** 1", 2", 3", 4", 5", 6"
Type: Double Acting

To order: Indicate stroke in box □

Add **-N** to the end of the part number for a non-threaded rod

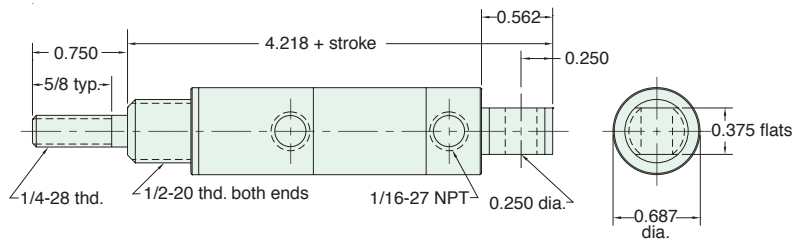

Nuts included, but not shown on drawing

H9D-□D

Mount: Stud **Available Stroke Lengths:** 1", 2", 3", 4", 5", 6"
Type: Double Acting Double Rod

To order: Indicate stroke in box □

Add **-N** to the end of the part number for a non-threaded rod

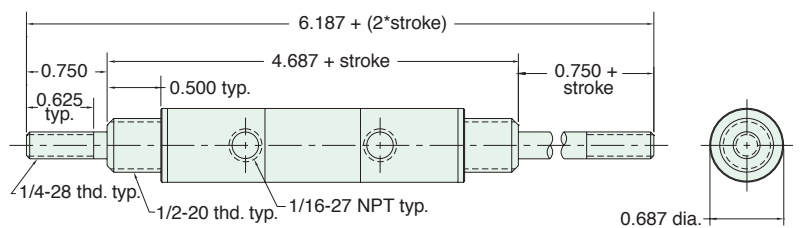
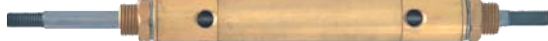

Nuts included, but not shown on drawing